



# Texas Department of Transportation

2591 N. EARL RUDDER FREEWAY | BRYAN, TEXAS 77803-5190 | (979) 778-2165 | WWW.TXDOT.GOV

July 21, 2022

Mr. Bryan Burns  
Emergency Management Coordinator  
102 S Fannin, Suite 2  
Cameron, TX 76520

Re: FM 845 Rehabilitation Project  
CSJ: 0185-06-012, Etc.  
Milam County

Dear Mr. Burns:

The Bryan District of the Texas Department of Transportation (TxDOT) will soon begin road work on FM 845 from US 190 to FM 1600 and on FM 1600 from FM 845 to South Crockett Avenue in Cameron. The purpose of this letter is to provide advance notice of a roadway closure which will occur during the construction of this project. The project is anticipated to begin during the fall of this year.

During this project, FM 845 will be closed for reconstruction from 0.3 miles east of US 190 to 0.9 miles east of US 190. The roadway will be closed for an estimated two months and TxDOT has identified a temporary detour route for use during the roadway closure. See the attached map for the designated detour route.

Please complete the bottom portion of this letter and return in the self-addressed envelope or email to [Keith.Kouba@txdot.gov](mailto:Keith.Kouba@txdot.gov) to acknowledge receipt of this letter. A second copy of this letter has been enclosed for your records. If you have questions or need additional information, please contact Keith Kouba, P.E. at (979) 778-9797.

Respectfully,

Doug Marino, P.E.  
Director of Transportation Planning and Development  
TxDOT-Bryan District

Bryan Burns  
Signature  
Bryan Burns  
Print Name  
Milam CO EMC  
Title

8-17-22  
Date  
254-258-8975  
Phone Number  
bburns@milamcounty.net  
Email Address

OUR GOALS  
MAINTAIN A SAFE SYSTEM ▪ ADDRESS CONGESTION ▪ CONNECT TEXAS COMMUNITIES ▪ BEST IN CLASS STATE AGENCY

An Equal Opportunity Employer

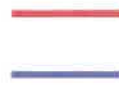

DETOUR ROUTE  
PROJECT LOCATION

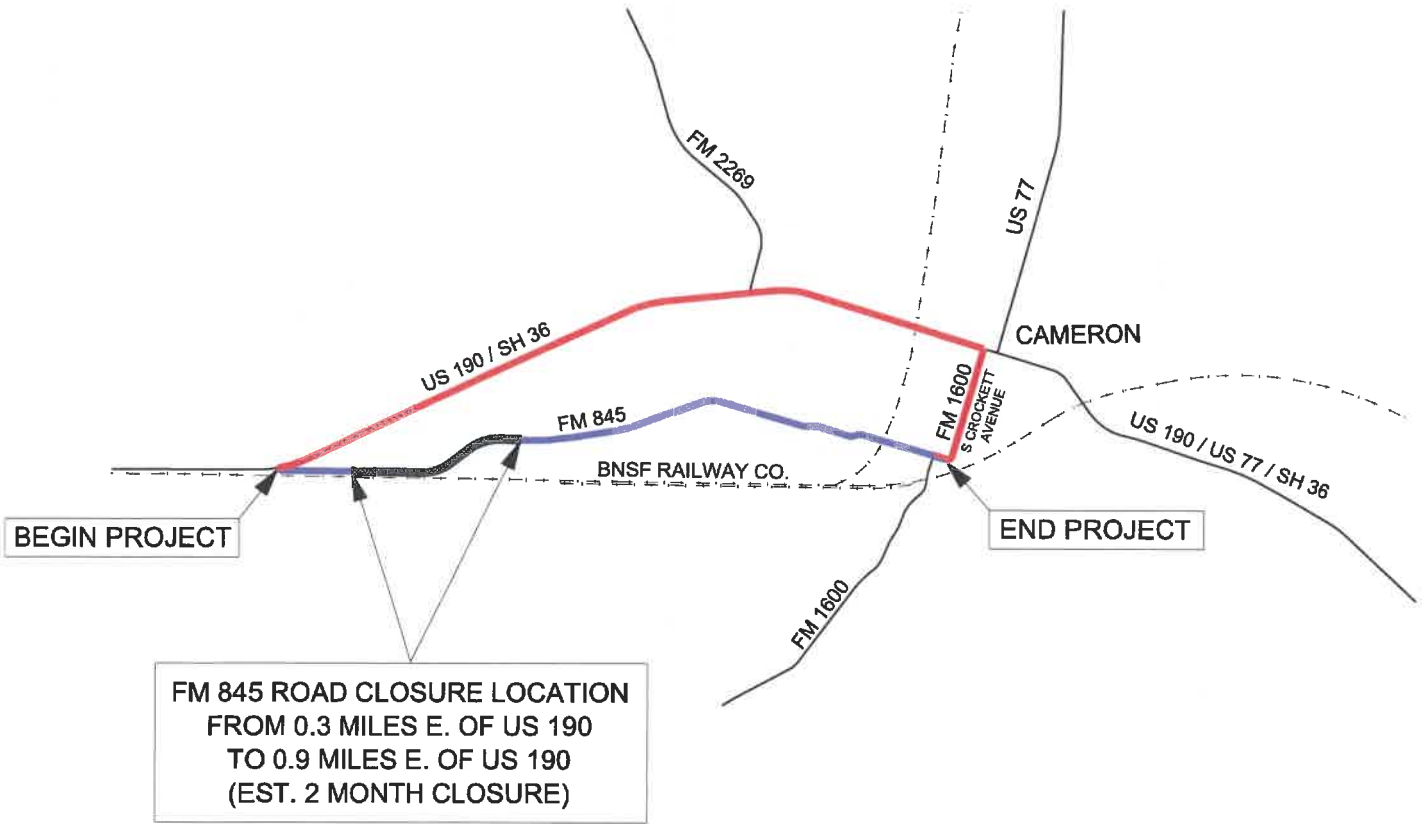

CAMERON, TEXAS

NOT TO SCALE

PRINT DATE	REVISION DATE
------------	---------------



Texas Department of Transportation ©2021  
Bryan District

**FM 845  
ROAD CLOSURE LOCATION  
& DETOUR MAP**

FED. RD. DIV. NO.	PROJECT NUMBER	HIGHWAY NUMBER	
6		FM 845	
STATE	DISTRICT	COUNTY	
TEXAS	BRYAN	MILAM	
CONTROL	SECTION	JOB	SHEET NO.
0185	06	012, ETC.	